



MAVERICKS INTERNATIONAL SCHOOL

AFFILIATED TO C.B.S.E.

Ref No.

Dated.....

INFRASTRUCTURAL DETAILS

Total Area:	12246.18 sq.mt.
Covered Area (Ground floor plain):	1059.98 sq.mt.
Playground Area:	6970.26 sq.mt.
Open/Green Area:	4215.94 sq.mt.

Sr.No.	ROOM	NUMBER	LENGTH	BREADTH	TOTAL
1	Class Room	10	26	21	5460
2	Vacant Room	7	26	21	3822
3	Sports Room	1	26	21	546
4	Principal Room	1	20	20	400
5	Staff Room	1	27	15	405
6	Pantry	1	10	10	100
7	Medical Room	1	14	10	140
8	Counsellor Room	1	13	11	143
9	Math's Lab	1	26	21	546
10	Computer Lab	1	42	27	1134
11	Chemistry lab	1	42	27	1134
12	Physics lab	1	42	27	1134
13	Biology Lab	1	42	27	1134
14	Reception/Accounts	1	46	27	1242
15	Library	1	45	27	1215
16	Store Room	1	48	16	768
17	Boy's Toilet/urinal	8+6	21	13	273
18	Girl's Toilet	8	21	13	273
19	Staff Toilets	4	6	6	144

नकल अम्बा प्रकाश भाव पत्ता मनारवल हदद न. 138

तदलील मुलाना जिला अम्बाला

मेम्बाना काहेराल

1 इंच = 40 कर्म
1 किला = 36 x 40 कर्म

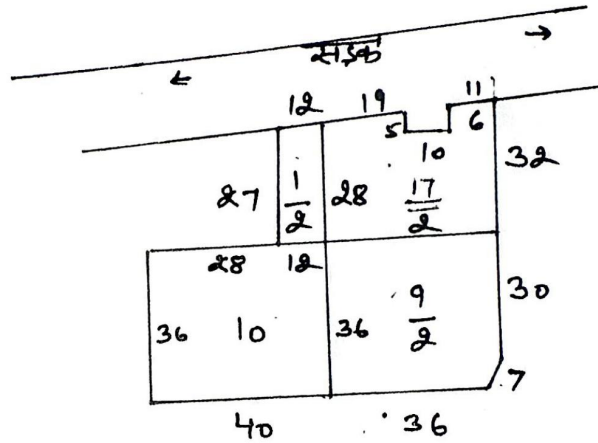
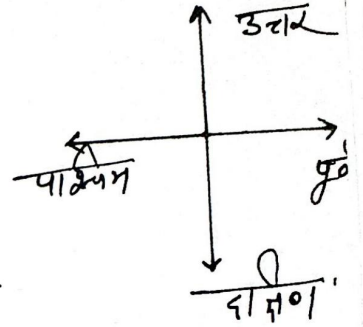

श्री मन जी
नकल मुलाना
को केंचर
हस्य जावना

श्रीम प्रकाश
16/9/2020

S. P. Singh
Principal
Mavericks International School
MULLANA (Ambala)